

## ELEVATION CERTIFICATE

Important: Follow the instructions on pages 1-9.

JUN 27 2016

Copy all pages of this Elevation Certificate and all attachments for (1) community official, (2) insurance agent/company, and (3) building owner.

SECTION A – PROPERTY INFORMATION				FOR INSURANCE COMPANY USE	
A1. Building Owner's Name Clettus and Jane Schwegman				Policy Number:	
A2. Building Street Address (including Apt., Unit, Suite, and/or Bldg. No.) or P.O. Route and Box No. 33 N. Manor Avenue				Company NAIC Number:	
City Borough of Longport		State New Jersey		ZIP Code 08403	
A3. Property Description (Lot and Block Numbers, Tax Parcel Number, Legal Description, etc.) Lot No. 7, Block 56, Tax Map					
A4. Building Use (e.g., Residential, Non-Residential, Addition, Accessory, etc.) _____					
A5. Latitude/Longitude: Lat. <u>39-19-4.30</u> Long. <u>74-31-31.64</u> Horizontal Datum: <input checked="" type="checkbox"/> NAD 1927 <input type="checkbox"/> NAD 1983					
A6. Attach at least 2 photographs of the building if the Certificate is being used to obtain flood insurance.					
A7. Building Diagram Number <u>9</u>					
A8. For a building with a crawlspace or enclosure(s):					
a) Square footage of crawlspace or enclosure(s) <u>1,194.43</u> sq ft					
b) Number of permanent flood openings in the crawlspace or enclosure(s) within 1.0 foot above adjacent grade <u>6</u>					
c) Total net area of flood openings in A8.b <u>1,200</u> sq in					
d) Engineered flood openings? <input checked="" type="checkbox"/> Yes <input type="checkbox"/> No					
A9. For a building with an attached garage:					
a) Square footage of attached garage _____ sq ft					
b) Number of permanent flood openings in the attached garage within 1.0 foot above adjacent grade _____					
c) Total net area of flood openings in A9.b _____ sq in					
d) Engineered flood openings? <input type="checkbox"/> Yes <input type="checkbox"/> No					
SECTION B – FLOOD INSURANCE RATE MAP (FIRM) INFORMATION					
B1. NFIP Community Name & Community Number Borough Of Longport 345302			B2. County Name Atlantic		B3. State New Jersey
B4. Map/Panel Number 345302 0001	B5. Suffix B	B6. FIRM Index Date 08/15/1993	B7. FIRM Panel Effective/ Revised Date 08/15/1993	B8. Flood Zone(s) A-8	B9. Base Flood Elevation(s) (Zone AO, use Base Flood Depth) EL: 10.00'
B10. Indicate the source of the Base Flood Elevation (BFE) data or base flood depth entered in Item B9: <input type="checkbox"/> FIS Profile <input checked="" type="checkbox"/> FIRM <input type="checkbox"/> Community Determined <input type="checkbox"/> Other/Source: _____					
B11. Indicate elevation datum used for BFE in Item B9: <input checked="" type="checkbox"/> NGVD 1929 <input type="checkbox"/> NAVD 1988 <input type="checkbox"/> Other/Source: _____					
B12. Is the building located in a Coastal Barrier Resources System (CBRS) area or Otherwise Protected Area (OPA)? <input type="checkbox"/> Yes <input checked="" type="checkbox"/> No Designation Date: _____ <input type="checkbox"/> CBRS <input type="checkbox"/> OPA					

**ELEVATION CERTIFICATE**

OMB No. 1660-0008  
Expiration Date: November 30, 2018

<b>IMPORTANT: In these spaces, copy the corresponding information from Section A.</b>			<b>FOR INSURANCE COMPANY USE</b>
Building Street Address (including Apt., Unit, Suite, and/or Bldg. No.) or P.O. Route and Box No. 33 N. Manor Avenue			Policy Number:
City Borough of Longport	State New Jersey	ZIP Code 08403	Company NAIC Number

**SECTION C – BUILDING ELEVATION INFORMATION (SURVEY REQUIRED)**

C1. Building elevations are based on:  Construction Drawings\*  Building Under Construction\*  Finished Construction

\*A new Elevation Certificate will be required when construction of the building is complete.

C2. Elevations – Zones A1–A30, AE, AH, A (with BFE), VE, V1–V30, V (with BFE), AR, AR/A, AR/AE, AR/A1–A30, AR/AH, AR/AO. Complete Items C2.a–h below according to the building diagram specified in Item A7. In Puerto Rico only, enter meters.

Benchmark Utilized: GPS Static Sit Vertical Datum: NAVD 1929

Indicate elevation datum used for the elevations in items a) through h) below.

NGVD 1929  NAVD 1988  Other/Source: \_\_\_\_\_

Datum used for building elevations must be the same as that used for the BFE.

Check the measurement used.

- a) Top of bottom floor (including basement, crawlspace, or enclosure floor) 6.8  feet  meters
- b) Top of the next higher floor 13.31  feet  meters
- c) Bottom of the lowest horizontal structural member (V Zones only) N/A  feet  meters
- d) Attached garage (top of slab) N/A  feet  meters
- e) Lowest elevation of machinery or equipment servicing the building (Describe type of equipment and location in Comments) 11.29  feet  meters
- f) Lowest adjacent (finished) grade next to building (LAG) 6.59  feet  meters
- g) Highest adjacent (finished) grade next to building (HAG) 6.62  feet  meters
- h) Lowest adjacent grade at lowest elevation of deck or stairs, including structural support 6.79  feet  meters

**SECTION D – SURVEYOR, ENGINEER, OR ARCHITECT CERTIFICATION**

This certification is to be signed and sealed by a land surveyor, engineer, or architect authorized by law to certify elevation information. I certify that the information on this Certificate represents my best efforts to interpret the data available. I understand that any false statement may be punishable by fine or imprisonment under 18 U.S. Code, Section 1001.

Were latitude and longitude in Section A provided by a licensed land surveyor?  Yes  No  Check here if attachments.

Certifier's Name William B. Reale, P.L.S.	License Number 17433	Place Seal Here
Title President		
Company Name Reale Associates, LLC		
Address 1068 E. Landis Avenue		
City Vineland	State New Jersey	
Signature 	Date 06/22/2016	Telephone (856) 692-4342

Copy all pages of this Elevation Certificate and all attachments for (1) community official, (2) insurance agent/company, and (3) building owner.

Comments (including type of equipment and location, per C2(e), if applicable)  
Mechanical Platform elevation = 13.31', All vents are smart vents model # 1540-510, Lowest HAVC (duct work) EL: 11.29'

**BUILDING PHOTOGRAPHS**

See Instructions for Item A6.

OMB No. 1660-0008  
Expiration Date: November 30, 2018

**ELEVATION CERTIFICATE**

<b>IMPORTANT: In these spaces, copy the corresponding information from Section A.</b>			<b>FOR INSURANCE COMPANY USE</b>
Building Street Address (including Apt., Unit, Suite, and/or Bldg. No.) or P.O. Route and Box No. 33 N. Manor Avenue			Policy Number:
City Borough of Longport	State New Jersey	ZIP Code 08403	Company NAIC Number

If using the Elevation Certificate to obtain NFIP flood insurance, affix at least 2 building photographs below according to the instructions for Item A6. Identify all photographs with date taken; "Front View" and "Rear View"; and, if required, "Right Side View" and "Left Side View." When applicable, photographs must show the foundation with representative examples of the flood openings or vents, as indicated in Section A8. If submitting more photographs than will fit on this page, use the Continuation Page.

6/22/16

Photo



REAR VIEW

Photo One

Photo One Caption

6/22/16

Photo T



RIGHT SIDE VIEW

Photo Two

Photo Two Caption

**ELEVATION CERTIFICATE**

**BUILDING PHOTOGRAPHS**

Continuation Page

OMB No. 1660-0008  
Expiration Date: November 30, 2018

<b>IMPORTANT: In these spaces, copy the corresponding information from Section A.</b>			<b>FOR INSURANCE COMPANY USE</b>
Building Street Address (including Apt., Unit, Suite, and/or Bldg. No.) or P.O. Route and Box No. 33 N. Manor Avenue			Policy Number:
City Borough of Longport	State New Jersey	ZIP Code 08403	Company NAIC Number

If submitting more photographs than will fit on the preceding page, affix the additional photographs below. Identify all photographs with: date taken; "Front View" and "Rear View"; and, if required, "Right Side View" and "Left Side View." When applicable, photographs must show the foundation with representative examples of the flood openings or vents, as indicated in Section A8.

FRONT VIEW  
6/22/16



Photo One

Photo One Caption

LEFT SIDE VIEW  
6/22/16



Photo Two

Photo Two Caption



Most Widely Accepted and Trusted

# ICC-ES Report

## ESR-2074

ICC-ES | (800) 423-6587 | (562) 699-0543 | www.icc-es.org

Reissued 02/2015  
This report is subject to renewal 02/2017.

DIVISION: 08 00 00—OPENINGS

SECTION: 08 95 43—VENTS/FOUNDATION FLOOD VENTS



REPORT HOLDER:

JUN 27 2016

**SMARTVENT PRODUCTS, INC.**

430 ANDBRO DRIVE, UNIT 1  
PITMAN, NEW JERSEY 08071

EVALUATION SUBJECT:

SMART VENT® AUTOMATIC FOUNDATION FLOOD VENTS: MODELS #1540-520; #1540-521; #1540-510;  
#1540-511; #1540-570; #1540-574; #1540-524; #1540-514



Look for the trusted marks of Conformity!

*"2014 Recipient of Prestigious Western States Seismic Policy Council (WSSPC) Award in Excellence"*



A Subsidiary of INTERNATIONAL CODE COUNCIL

ICC-ES Evaluation Reports are not to be construed as representing aesthetics or any other attributes not specifically addressed, nor are they to be construed as an endorsement of the subject of the report or a recommendation for its use. There is no warranty by ICC Evaluation Service, LLC, express or implied, as to any finding or other matter in this report, or as to any product covered by the report.



**ICC-ES Evaluation Report**
**ESR-2074\***

Reissued February 2015

This report is subject to renewal February 2017.

[www.icc-es.org](http://www.icc-es.org) | (800) 423-6587 | (562) 699-0543

A Subsidiary of the International Code Council®

**DIVISION: 08 00 00—OPENINGS**
**Section: 08 95 43—Vents/Foundation Flood Vents**
**REPORT HOLDER:**
**SMARTVENT PRODUCTS, INC.**  
 430 ANDBRO DRIVE, UNIT 1  
 PITMAN, NEW JERSEY 08071  
 (877) 441-8368

[www.smartvent.com](http://www.smartvent.com)  
[info@smartvent.com](mailto:info@smartvent.com)
**EVALUATION SUBJECT:**
**SMART VENT® AUTOMATIC FOUNDATION FLOOD VENTS:  
 MODELS #1540-520; #1540-521; #1540-510; #1540-511;  
 #1540-570; #1540-574; #1540-524; #1540-514**
**1.0 EVALUATION SCOPE**
**Compliance with the following codes:**

- 2012, 2009 and 2006 *International Building Code*® (IBC)
- 2012, 2009 and 2006 *International Residential Code*® (IRC)
- 2013 *Abu Dhabi International Building Code* (ADIBC)<sup>†</sup>

<sup>†</sup>The ADIBC is based on the 2009 IBC. 2009 IBC code sections referenced in this report are the same sections in the ADIBC.

**Properties evaluated:**

- Physical operation
- Water flow

**2.0 USES**

The Smart Vent® units are engineered mechanically operated flood vents (FVs) employed to equalize hydrostatic pressure on walls of enclosures subject to rising or falling flood waters. Certain models also allow natural ventilation.

**3.0 DESCRIPTION**
**3.1 General:**

When subjected to rising water, the Smart Vent® FVs internal floats are activated, then pivot open to allow flow in either direction to equalize water level and hydrostatic pressure from one side of the foundation to the other. The FV pivoting door is normally held in the closed position by a buoyant release device. When subjected to rising water, the buoyant release device causes the unit to unlatch, allowing the door to rotate out of the way and allow flow.

The water level stabilizes, equalizing the lateral forces. Each unit is fabricated from stainless steel. Smart Vent® Automatic Foundation Flood Vents are available in various models and sizes as described in Table 1. The SmartVENT® Stacking Model #1540-511 and FloodVENT® Stacking Model #1540-521 units each contain two vertically arranged openings per unit.

**3.2 Engineered Opening:**

The FVs comply with the design principle noted in Section 2.6.2.2 of ASCE/SEI 24 for a maximum rate of rise and fall of 5.0 feet per hour (0.423 mm/s). In order to comply with the engineered opening requirement of ASCE/SEI 24, Smart Vent FVs must be installed in accordance with Section 4.0.

**3.3 Ventilation:**

The SmartVENT® Model #1540-510 and SmartVENT® Overhead Door Model #1540-514 both have screen covers with 1/4-inch-by-1/4-inch (6.35 by 6.35 mm) openings, yielding 51 square inches (32 903 mm<sup>2</sup>) of net free area to supply natural ventilation. The SmartVENT® Stacking Model #1540-511 consists of two Model #1540-510 units in one assembly, and provides 102 square inches (65 806 mm<sup>2</sup>) of net free area to supply natural ventilation. Other FVs recognized in this report do not offer natural ventilation.

**4.0 DESIGN AND INSTALLATION**

SmartVENT® and FloodVENT® are designed to be installed into walls or overhead doors of existing or new construction from the exterior side. Installation of the vents must be in accordance with the manufacturer's instructions, the applicable code and this report. The mounting straps allow mounting in masonry and concrete walls up to 12 inches (305 mm) thick. In order to comply with the engineered opening design principle noted in Section 2.6.2.2 of ASCE/SEI 24, the Smart Vent® FVs must be installed as follows:

- With a minimum of two openings on different sides of each enclosed area.
- With a minimum of one FV for every 200 square feet (18.6 m<sup>2</sup>) of enclosed area, except that the SmartVENT® Stacking Model #1540-511 and FloodVENT® Stacking Model #1540-521 must be installed with a minimum of one FV for every 400 square feet (37.2 m<sup>2</sup>) of enclosed area.
- Below the base flood elevation.
- With the bottom of the FV located a maximum of 12 inches (305.4 mm) above the higher of the final

\*Revised July 2015

grade or floor and finished exterior grade immediately under each opening.

#### 5.0 CONDITIONS OF USE

The Smart Vent® FVs described in this report comply with, or are suitable alternatives to what is specified in, those codes listed in Section 1.0 of this report, subject to the following conditions:

- 5.1 The Smart Vent® FVs must be installed in accordance with this report, the applicable code and the manufacturer's installation instructions. In the event of a conflict, the instructions in this report govern.
- 5.2 The Smart Vent® FVs must not be used in the place of "breakaway walls" in coastal high hazard areas, but

are permitted for use in conjunction with breakaway walls in other areas.

#### 6.0 EVIDENCE SUBMITTED

Data in accordance with the ICC-ES Acceptance Criteria for Mechanically Operated Flood Vents (AC364), dated October 2013 (editorially revised May 2014).

#### 7.0 IDENTIFICATION

The Smart VENT® models recognized in this report must be identified by a label bearing the manufacturer's name (Smartvent Products, Inc.), the model number, and the evaluation report number (ESR-2074).

TABLE 1—MODEL SIZES

MODEL NAME	MODEL NUMBER	MODEL SIZE (in.)	COVERAGE (sq. ft.)
FloodVENT®	1540-520	15 <sup>3</sup> / <sub>4</sub> " X 7 <sup>3</sup> / <sub>4</sub> "	200
SmartVENT®	1540-510	15 <sup>3</sup> / <sub>4</sub> " X 7 <sup>3</sup> / <sub>4</sub> "	200
FloodVENT® Overhead Door	1540-524	15 <sup>3</sup> / <sub>4</sub> " X 7 <sup>3</sup> / <sub>4</sub> "	200
SmartVENT® Overhead Door	1540-514	15 <sup>3</sup> / <sub>4</sub> " X 7 <sup>3</sup> / <sub>4</sub> "	200
Wood Wall FloodVENT®	1540-570	14" X 8 <sup>3</sup> / <sub>4</sub> "	200
Wood Wall FloodVENT® Overhead Door	1540-574	14" X 8 <sup>3</sup> / <sub>4</sub> "	200
SmartVENT® Stacker	1540-511	16" X 16"	400
FloodVent® Stacker	1540-521	16" X 16"	400

For SI: 1 inch = 25.4 mm; 1 square foot = m<sup>2</sup>

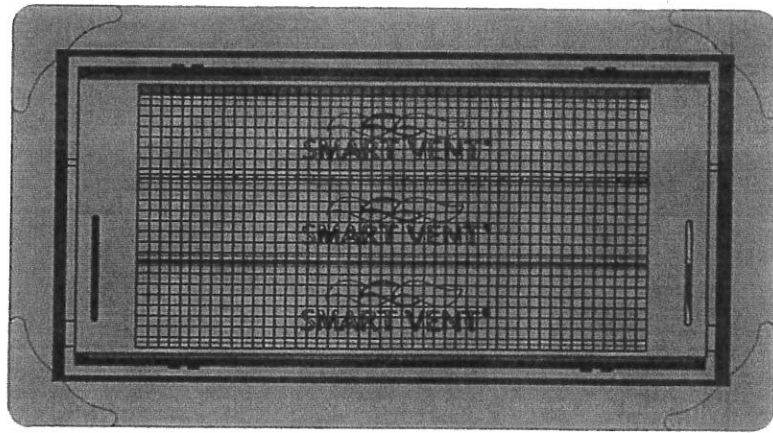

FIGURE 1—SMART VENT: MODEL 1540-510

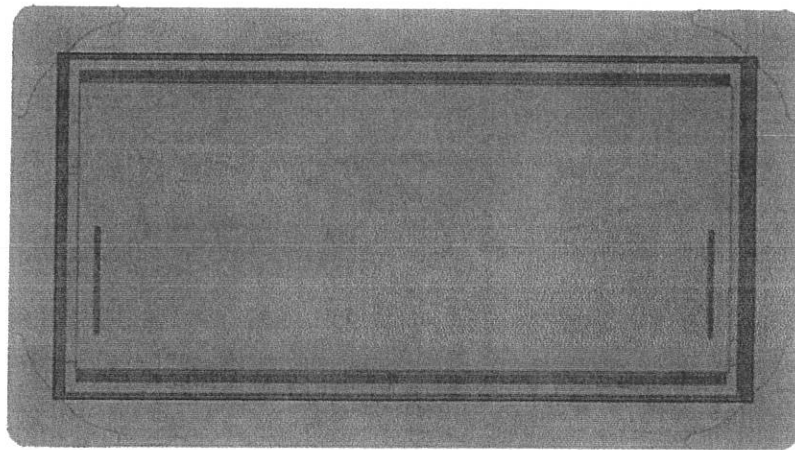

FIGURE 2—SMART VENT MODEL 1540-520

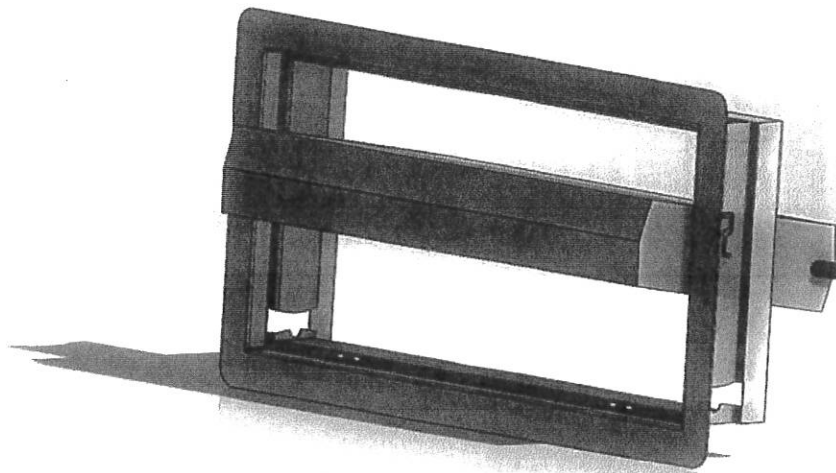

FIGURE 3—SMART VENT: SHOWN WITH FLOOD DOOR PIVOTED OPEN



**ICC-ES Evaluation Report****ESR-2074 FBC Supplement\***

Reissued February 2015

*This report is subject to renewal February 2017.***www.icc-es.org | (800) 423-6587 | (562) 699-0543***A Subsidiary of the International Code Council®***DIVISION: 08 00 00—OPENINGS****Section: 08 95 43—Vents/Foundation Flood Vents****REPORT HOLDER:****SMARTVENT PRODUCTS, INC.  
430 ANDBRO DRIVE, UNIT 1  
PITMAN, NEW JERSEY 08071  
(877) 441-8368  
[www.smartvent.com](http://www.smartvent.com)  
[info@smartvent.com](mailto:info@smartvent.com)****EVALUATION SUBJECT:****SMART VENT® AUTOMATIC FOUNDATION FLOOD VENTS: MODELS #1540-520; #1540-521; #1540-510; #1540-511; #1540-570; #1540-574; #1540-524; #1540-514****1.0 REPORT PURPOSE AND SCOPE****Purpose:**

The purpose of this evaluation report supplement is to indicate that Smart Vent® Automatic Foundation Flood Vents, recognized in ICC-ES master report ESR-2074, have also been evaluated for compliance with the codes noted below.

**Applicable code editions:**

- 2014 *Florida Building Code—Building* (FBC)
- 2014 *Florida Building Code—Residential* (FRC)

**2.0 CONCLUSIONS**

The Smart Vent® Automatic Foundation Flood Vents, described in Sections 2.0 through 7.0 of the master evaluation report ESR-2074, comply with the FBC and the FRC, provided the design and installation are in accordance with the *International Building Code®* provisions noted in the master report.

Use of the Smart Vent® Automatic Foundation Flood Vents has also been found to be in compliance with the High-Velocity Hurricane Zone provisions of the FBC and the FRC.

For products falling under Florida Rule 9N-3, verification that the report holder's quality assurance program is audited by a quality assurance entity approved by the Florida Building Commission for the type of inspections being conducted is the responsibility of an approved validation entity (or the code official when the report holder does not possess an approval by the Commission).

This supplement expires concurrently with the master report, reissued February 2015 and revised July 2015.

**\*Revised July 2015**